













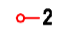

ELECTRICAL LEGEND

-  13A DOUBLE SOCKET AT LOW LEVEL
-  SWITCHED SPUR AT LOW LEVEL
-  13A DOUBLE SOCKET AT HIGH LEVEL
-  TV POINT
-  TELECOM POINT
-  1 GANG 1 WAY SWITCH
-  1 GANG 2 WAY SWITCH
-  CEILING POINT
-  EXTERNAL WALL LIGHT
-  CEILING MOUNTED MECHANICAL EXTRACT
-  WALL MOUNTED MECHANICAL EXTRACT
-  240V IONISATION SMOKE DETECTOR
-  COOKER CONTROL UNIT
-  RADIATOR
-  ELECTRICITY DISTRIBUTION BOARD

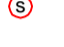

First Floor Plan

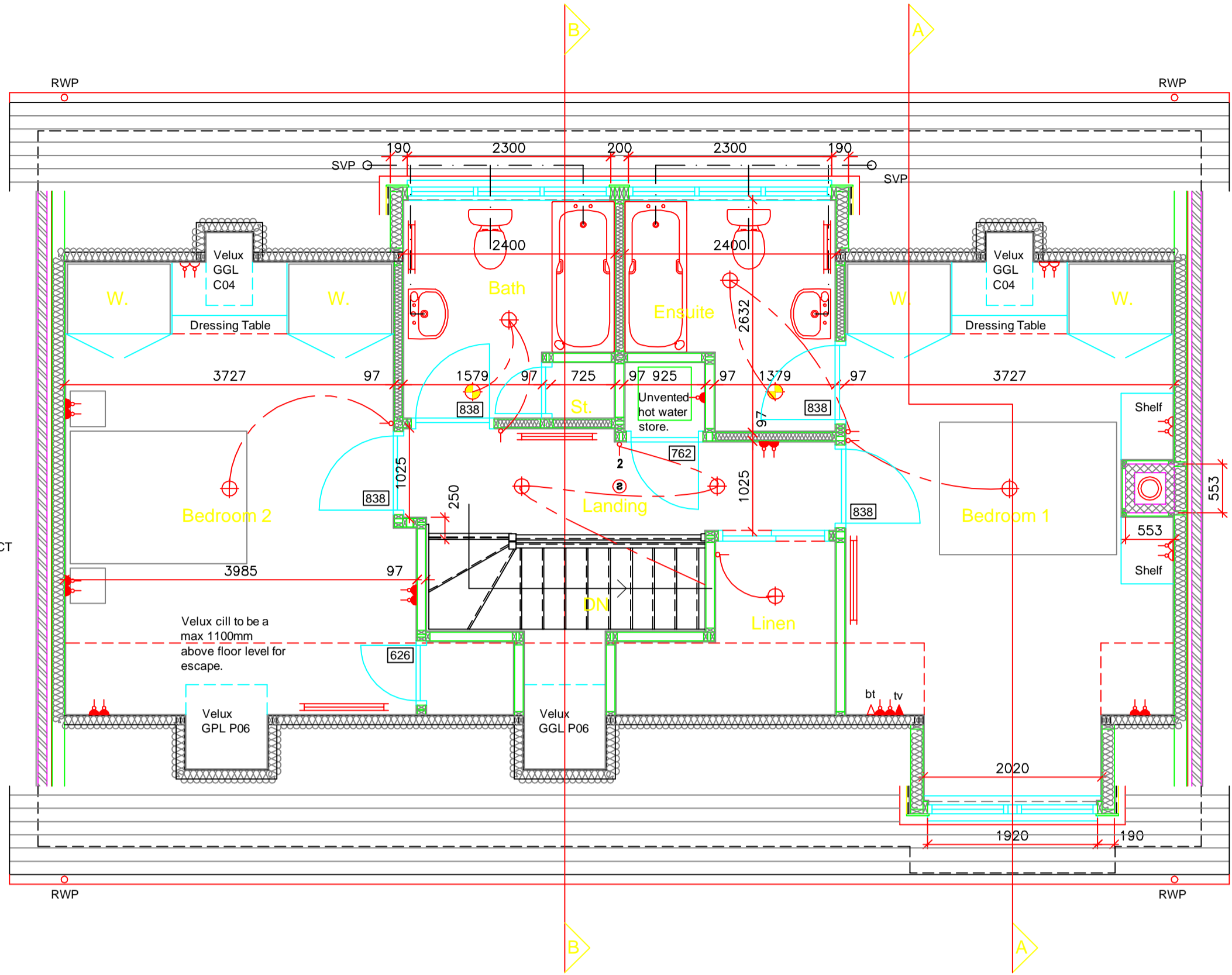
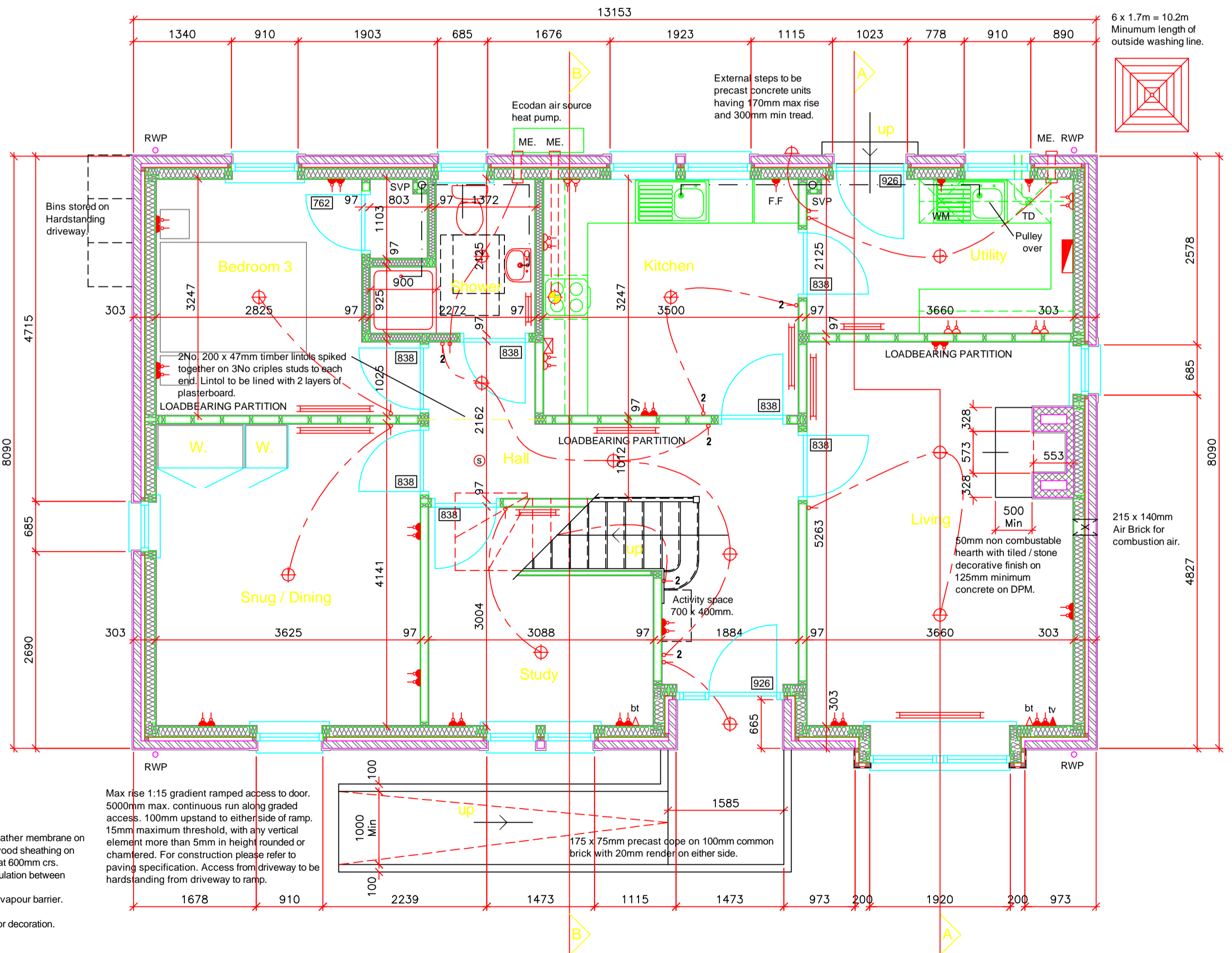

Ground Floor Plan

John Thomson Construction
Proposed Housing Development
Heathfield, Blackwaterfoot, Isle of Arran



JAMES HOUSTON
Architects

2, Schoolwynd, Kilbimie, Ayrshire, KA25 7AY
 Tel: 01505 682203 E-mail: mail@houstonarchitects.co.uk

Rev.B Drawings revised to suit Engineers details. 18/02/09
 Rev.A Various alterations to suit Building Standards. 18/02/09

Drwg. Title
Floor Plans

Scale 1:50
Date 16th Sept. 08

Drwg. No.
1112 - W01 B