

John Thomson Construction
 Proposed Housing Development
 Heathfield, Blackwaterfoot, Isle of Arran

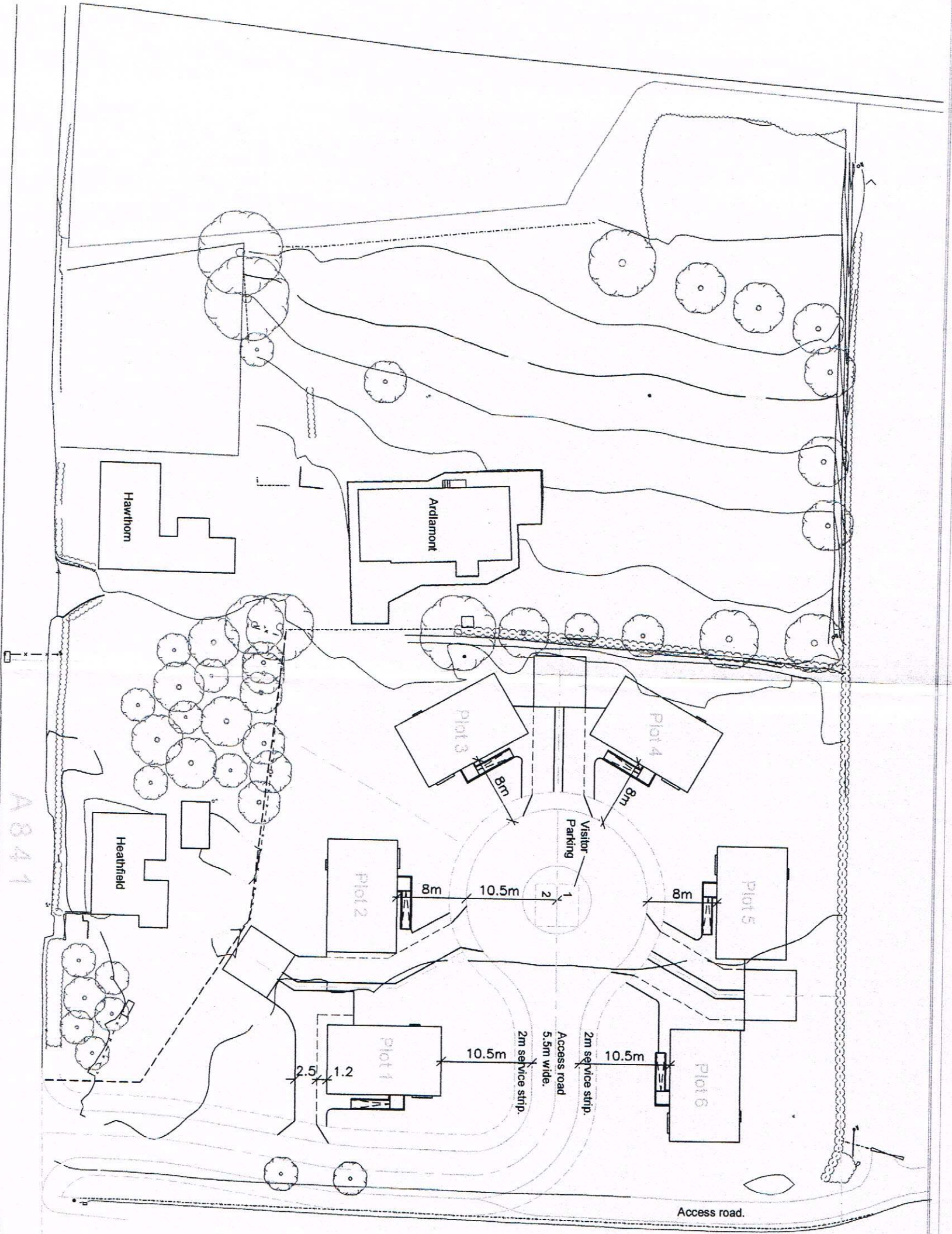

Concrete block paving to be Marshalls Keyblok. Colour to be Brindle.

19/07/12
 Rev C Road layout and roundabout size revised.
 Rev B Paving details and visitor parking added. 23/05/11
 Rev A Drainage details added to suit Building Standards. 20/04/09

JAMES HOUSTON
 Architects

2, Schoolwynd, Kibirnie, Ayrshire, KA25 7AY
 Tel: 01505 682203 E-mail: mail@houstonarchitects.co.uk

Drwg. Title	Site Plan
Scale	1:500
Date	25th Sept. 08
Drwg. No.	1112-SP1C